



***Dorothy Lake
Block 2, Lot 18
Lakefront
\$315,000***

- ◆ Beautiful location; fabulous view!
- ◆ 686 SF cottage
- ◆ 2 bedrooms
- ◆ Seasonal water system
- ◆ Regency woodstove
- ◆ Mainly wood interior
- ◆ Rock outcroppings near water's edge
- ◆ Deck on cottage overlooking water
- ◆ 21 year lease renewable 2022
- ◆ Great fishing on the Winnipeg River system
- ◆ Great hiking & canoeing
- ◆ Gently sloping lot
- ◆ Lot size: 100'(N/W), 150.54'(N/E), 96.34'(S/E)
- ◆ Shower & toilet
- ◆ Septic system & field
- ◆ Asphalt shingles (2010)
- ◆ Wood exterior
- ◆ Older boathouse & dock
- ◆ 200 AMP electrical service
- ◆ Annual lease fees (2010/11): \$686
- ◆ Approx. 80 minutes east of Winnipeg
- ◆ Excellent snowmobiling & cross country skiing

***Sampson's Realty Group
Phone: 369-5212 or 794-7473
Louise Sampson, Broker***



The information contained herein has been obtained through sources deemed reliable by Louise Sampson & Sampson's Realty Group, but cannot be guaranteed as to its accuracy. The buyer is advised to obtain independent verification of any information that is of material interest to them.









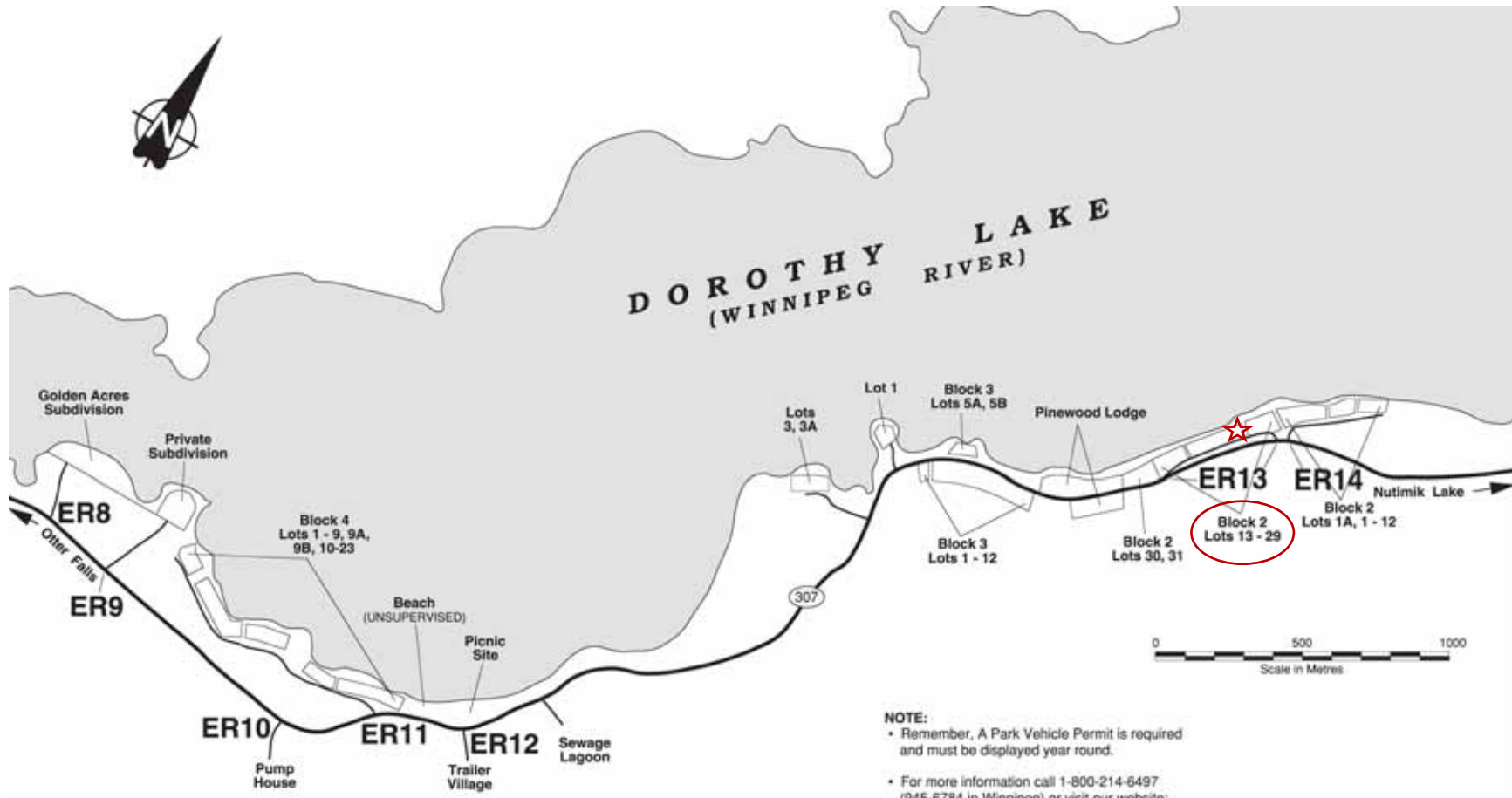

NOTE:

- Remember, A Park Vehicle Permit is required and must be displayed year round.
- For more information call 1-800-214-6497 (945-6784 in Winnipeg) or visit our website: www.manitobaparks.com

ER - Denotes Emergency Access Road

